



OPEN MEETING

4th July 2017

Richard Taunton College

southamptoncommonforum.org

[facebook.com/SouthamptonCommonForum](https://www.facebook.com/SouthamptonCommonForum)

@SotonCommonF #southamptoncommonforum



1. Welcome & Agenda

1. Welcome
2. Update on survey (Adam)
3. Update on Hawthorns consultation (Simon & Roger)
4. Update on new play area (Mitch)
5. Developing the Common Strategic Plan (Mitch & Adam)
6. Activities & Resources (Adam)



SCF Priorities & Activities

	Richer Engagement	Common Plan	Operating Model
Common Survey	X	X	X
Hawthorns Consultation	X	X	
SCC	X	X	X
Universities	X		
Lovers Walk	X		
Website/Facebook/ Twitter/email	X		



2. Update Common Survey 2017

- Previous survey in 1977 by The City of Southampton Society - 503 respondents.
- Purposes of the SCF Survey 2017:
 1. Identify public's key issues to inform plan and operating model in partnership with SCC.
 - Opinions about the management and the future of The Common.
 - Basic information about how The Common is currently used.
 2. Raise the profile and engagement of the public with Southampton Common Forum.



Emerging Results

- Launched May 2017; Over 1,000 respondents in first four weeks (Currently 1150 & rising)
- SCF subscribers have increased to c. 500
- Age distribution:

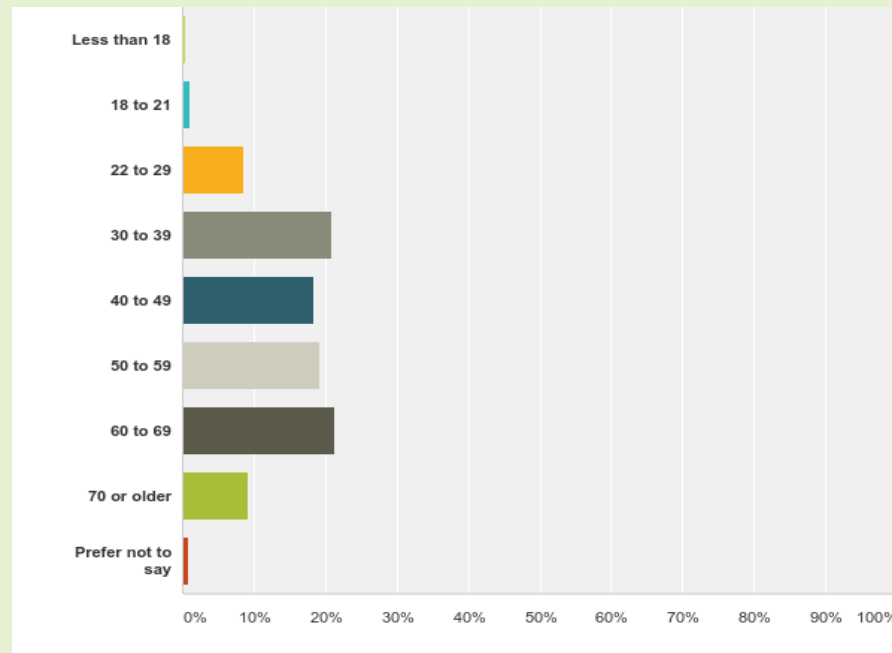



File Edit View History Bookmarks Tools Help

SCF survey respondees

https://www.google.com/maps/d/edit?mid=1dLp56d5r-kQM6Av0G-h6W-_zcVY&ll=50.92381616759738%2C-1.4166667690429904&sz=13

Most Visited UoS TGM Amazon eBay NAS NAS Webmail BIU Scheduler FoSSC FB OBRA FB SCF FB SCF WWW LCN Dropbox LHRR LHRR FB Lynda.com Google Analytics

SCF survey respondees
462 views
All changes saved in Drive
Add layer Share Preview
 responses to 2017 05 31
 responses to 2017 06 10
 responses to 2017 06 17
 responses to 2017 07 02
Uniform style
All items (1156)
Base map

Google My Maps

Map data ©2017 Google Terms

22:22



Top Priorities:

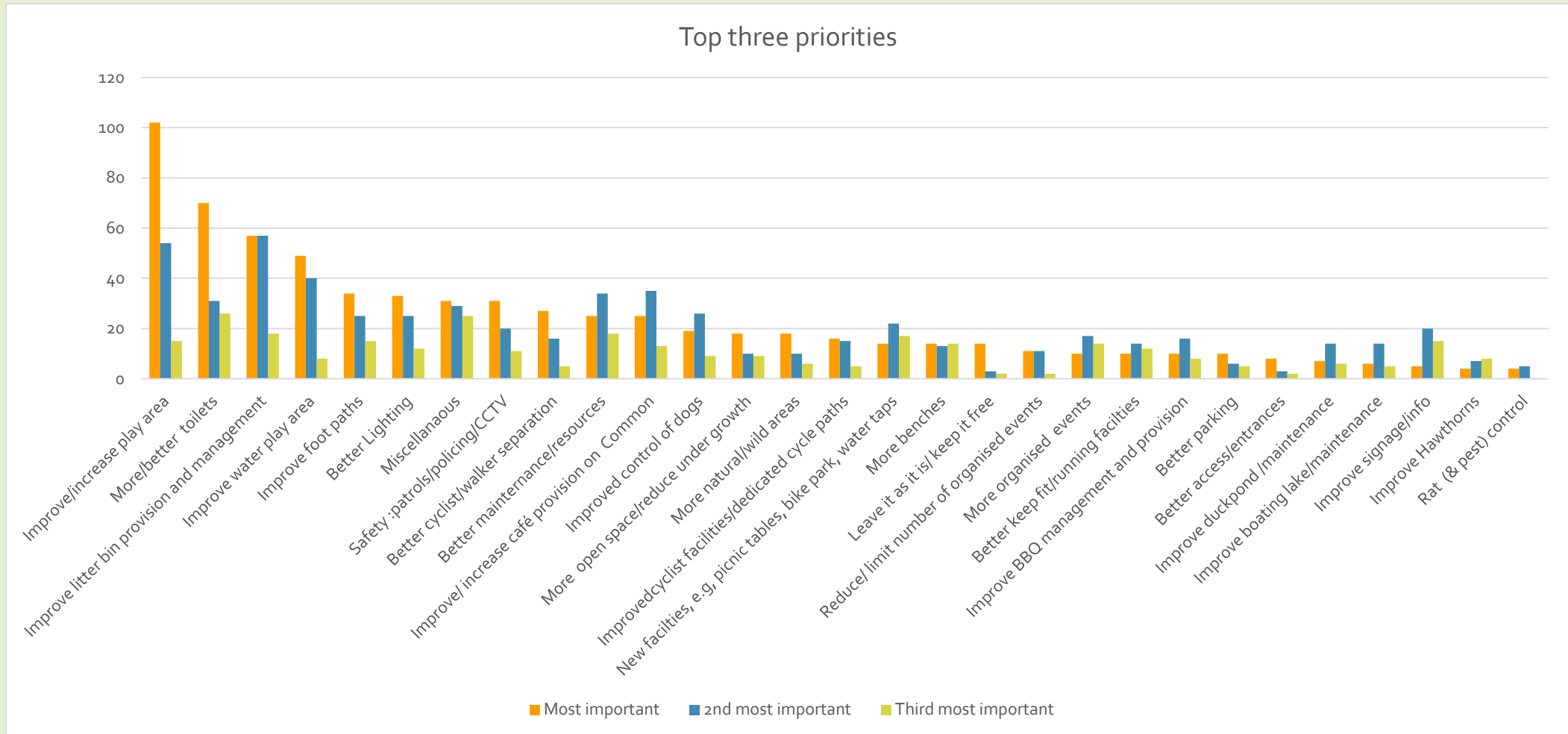



Survey Issues:

- Focus on:
 - Under 21's
 - BME communities
- How can we reach these groups more effectively?



Activities:

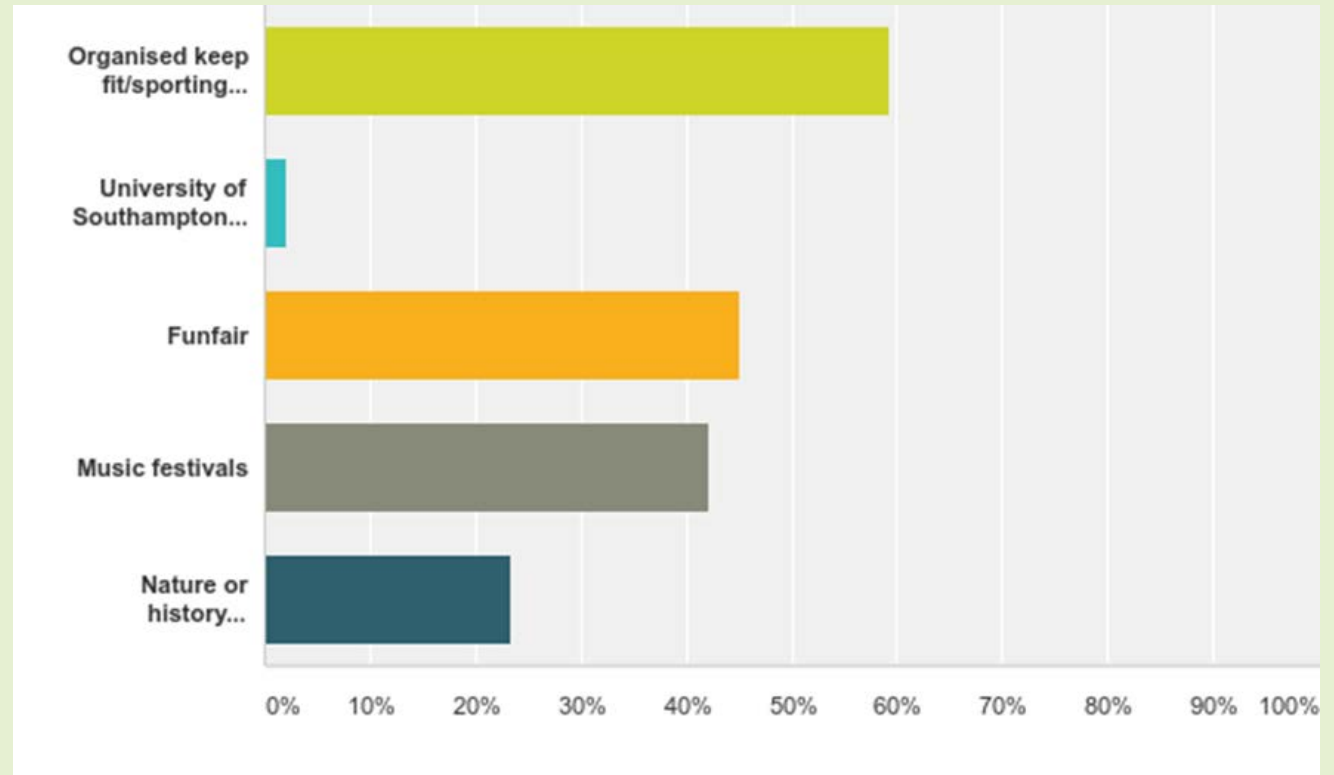
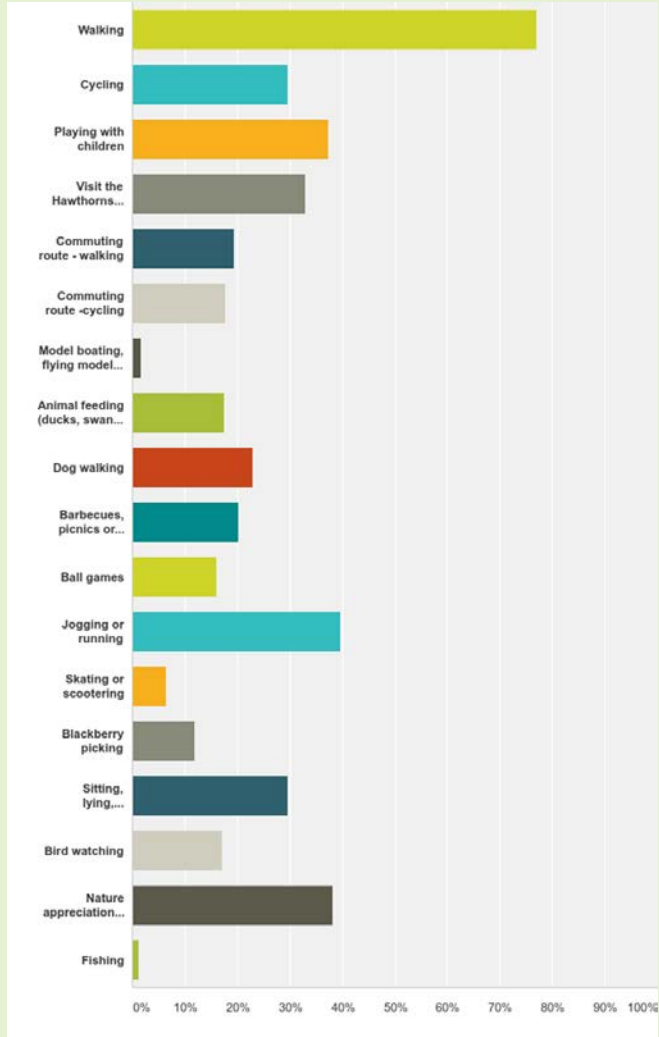



3. Hawthorns Consultation

- Simon Hill & Roger Brown



4. New play area: coming soon...

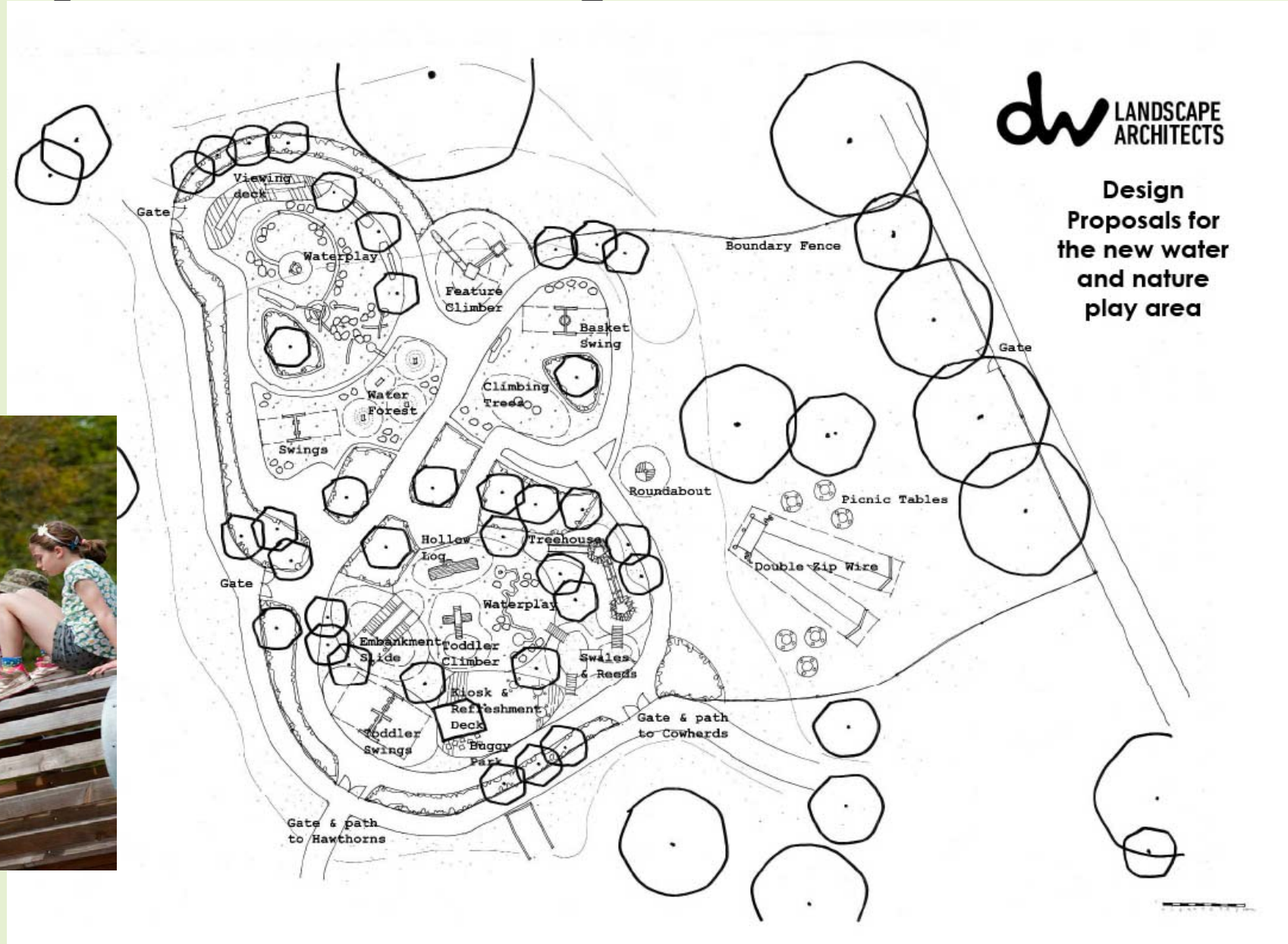



5. A Strategic Plan for The Common

- A New Plan to be developed;
- Southampton City Council to lead with SCF support;
- Joint Council/SCF Working Group (2017 Survey will be a key input);
- Wide Engagement and Consultation;
- Operating Model to be reviewed;
- Phased approach to be completed by July 2018.



Outline idea of a Strategic Plan

- **Management**
 - Overall aims, objectives and guiding principles;
- **Recreation**
 - Activities, Dog/Walking, Cycling, Sports, Play;
- **Events**
 - Major Festivals, 10k/Charity runs, Parkrun, Military Fitness, Fayres, Fun Fayres;
- **Wildlife**
 - SSSI, Protected species, Flora & Fauna, Habitats Management, Higher level stewardship, Conservation areas;
- **Health and Well Being**
 - Quiet contemplation, Secluded areas, Cycle/Running tracks - distance markers.



Group Exercise

At your tables:

Identify:

- Users and their activities
- Resources on the Common

- Case study:
 - Focus on one activity and consider the resources it requires and the associated issues.



6. Activities & Resources

- Survey & plan are our top priorities.
- We have a range of ideas for other things, e.g.
 - Photo competition
 - Treasure hunt
 - Map/app for The Common
 - Film of The Common
 - Historical archive of The Common
- We need resources to maintain and build our activities.
- **Without them we will fail!**



How can you help?

- Please consider donating at least £5 to SCF - details available from Shirley Pinn.
- Please donate your time, energy and expertise if you can:
 - Hawthorns facelift working party
 - Working parties on Common/Plan work
 - New initiatives
 - Management Committee
- Register your interest on the sign up sheet and also to talk to Committee members.



Making a donation

Donations to SCF may be made by online banking to:

Southampton Common Forum

Sort Code: 60-20-03

Account number 34669574

Cheques should be made out to Southampton Common Forum and sent to:

SCF, c/o 7 Oakmount Avenue, Southampton, SO17 1DS

Or can be handed to any SCF committee member.